

FRONT

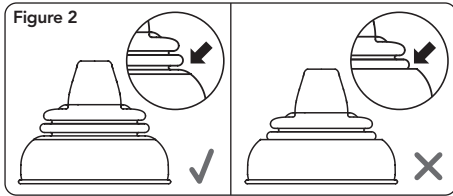

Make sure the 3rd segment under the accordion is resting above the collar. (see Figure 2)

Screw the collar onto the thread of the transition cup in a clockwise direction to securely tighten the collar. When assembling the cap, make sure to place the cap vertically onto the Transition Cup so the spout sits upright and is sealed.

CAUTION: Wash and inspect before first use. Do not microwave or use with hot liquids. Do not boil or sterilize. Discard and replace at first sign of damage. Always check temperature before drinking. Do not let child walk or run while carrying the cup. Spout is not intended to be used as a teether. Do not allow child to bite or chew on spout. Do not leave child unattended during use. Discard all packaging components before giving to the child.

PRODUCT AND DESIGN ARE TM & ©2013 MUNCHKIN, INC. MUNCHKIN, THE LATCH LOGO AND IT'S THE LITTLE THINGS ARE TRADEMARKS OR REGISTERED TRADEMARKS OF MUNCHKIN, INC. 7835 GLORIA AVE., VAN NUYS, CA 91406. PATENT: [HTTP://WWW.MUNCHKIN.COM/PATENTS](http://www.munchkin.com/patents). MADE IN CHINA.

munchkin
It's the little things.™

munchkin.com
800.344.2229

See how it works at
latchbottles.com

munchkin
LATCH™
4oz / 118ml
Transition Cup
Instructions



CCD-0115-001 REV1

BACK

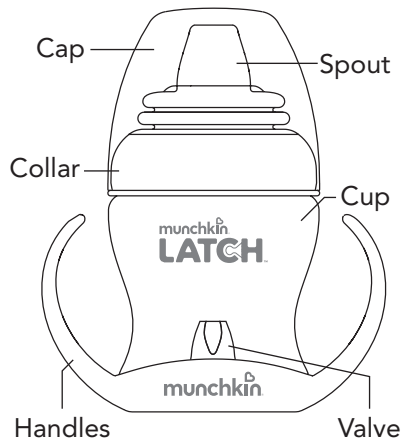

Instructions for use: Top rack dishwasher safe. Safe for all ages.

Cleaning and Maintenance: Carefully disassemble the LATCH™ Transition Cup. Wash all components with soap and hot water and rinse thoroughly. Use LATCH™ Deluxe Bottle Brush for best results. All cup parts are top rack dishwasher safe. For best results, use Munchkin® High Capacity Dishwasher Basket (available at munchkin.com) to secure spout, valve and collar during wash and dry cycles.

Assembly: Before each use, hold the tip of the valve (triangular head) up to the light to see the slit and pinch apart to ensure proper venting. When assembling your LATCH™ Transition Cup, first push the valve firmly through the hole at the bottom of the Transition Cup. Make sure that

the triangular head of the valve is fully inserted. A fully inserted valve will have a visible gap between the bottom edge of the triangular head and the hole opening at the bottom of the Transition Cup. You may not always see a gap unless you apply upward pressure with your thumb, as you inspect. (see Figure 1)

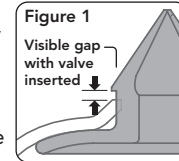

Pull the spout through the collar of your LATCH™ Transition Cup, making sure it is pulled all the way to the locked position. The locked position is when the base of the spout is flush against the upper rim of the collar (no gap). It is easier to assemble if you pull the spout back and forth and upwards, instead of pulling it straight up.